

KRISTI CHLEBOWSKI  
DANE COUNTY  
REGISTER OF DEEDS

DOCUMENT #  
5798341

12/17/2021 12:08 PM

Trans Fee:

Exempt #:

Rec. Fee: 30.00

Pages: 6

\*\*The above recording information  
verifies that this document has  
been electronically recorded and  
returned to the submitter.\*\*

Document No.

**CRESCENT CROSSING  
FIRST AMENDMENT TO  
DECLARATION OF PROTECTIVE COVENANTS,  
CONDITIONS AND RESTRICTIONS**

**CITY OF FITCHBURG, DANE COUNTY, WI.**

Return to:  
**Angie Christensen  
Veridian Homes  
6801 South Towne Drive  
Madison, WI53713**

**PREAMBLE**

See Exhibit "A"  
(Parcel Identification Numbers)

This is the First Amendment (the "Amendment") to that certain Declaration of Protective Covenants, Conditions and Restrictions dated January 27, 2021, recorded February 2, 2021 in the Office of the Dane County, Wisconsin Register of Deeds as Document No. 5690539 (the "Declaration"). This Amendment is made by VH CC, LLC, a Wisconsin Limited Liability Company (hereinafter referred to as the "Declarant") and/or its successors and assigns. Declarant hereby amends the Declaration as follows:

- 1) **Defined Terms.** Terms not otherwise defined herein shall be as defined in the Declaration.
- 2) Section B-11 is hereby deleted in its entirety and replaced with the following:  
"Signs. No sign of any kind shall be displayed to the public view on any Lot except, one professional sign of not more than one square foot, one sign of not more than six square feet advertising the property for sale or rent or signs without regard to size used by the Declarant, a builder or licensed real estate broker to advertise the property during the construction and sales period or to identify the subdivision and/or its Declarant. No signs by Lot Owners will be placed in the Outlots."

**Entrance Signs.** It is contemplated there will be an entrance monument sign and associated easement on Outlot 6. The sign and easement associated with the sign will be owned by the Association. The Association will be responsible for the maintenance of said sign to include watering, mowing and basic landscape maintenance. The Association is responsible for determining whether said signs shall remain in place. The Association shall assess all Owners maintenance and future replacement costs.”

- 3) Section B-21 is hereby added with the following: “**Landscape Buffers.** Outlots 5, 6 and 11 along South Seminole Highway are subject to a landscape buffer area (“Buffer”). The purpose of the Buffer is to provide a screen of vegetation to soften the edge between the Homesites and public roads and to use plant materials that are aesthetically and ecologically appropriate for the urban-natural edge and to avoid plants which may invade and cause management problems in the public right of way areas. Declarant, at its sole cost and expense, shall plant trees and shrubs in the Buffer. All Buffers shall be deemed part of the Common Property which the Association is obligated to maintain under the Declaration. No further plants may be installed in any Buffer area without written permission of the Association.

The Association, at its sole cost and expense, shall, maintain trees and shrubs within the Buffer areas in healthy condition and shall keep the turf mowed on a regular basis. The cost of maintenance of the Common Property shall be an assessment against all of the property in the Neighborhood, in accordance with the Declaration, for so long as such maintenance is necessary or required. Ground cover shall consist of natural material, including grass turf or wood mulch. Fencing, building structures, playground equipment and other structural items are prohibited within the Buffers.

- 4) Section B-22 is hereby added with the following: “**Stop/Signal Light Assessment.** At a future date the City of Fitchburg may install stop lights at certain intersections adjacent to entrances into Crescent Crossing and may assess the cost through an area wide assessment district, which assessment Owners will be responsible for.”
- 5) **Records.** Section C-6 shall be deleted and replaced with the following: “Until such time as a replacement Committee is designed, all plans, applications and requests shall be submitted to said Committee at the following address:

Crescent Crossing Homeowners Association, Inc.  
Architectural Control Committee  
c/o DSI Real Estate Group  
708 River Place  
Madison, Wisconsin 53713  
[acc@dsirealestate.com](mailto:acc@dsirealestate.com)”

- 6) **Effect of Amendment.** Except as amended herein, all terms, covenants and conditions of the Declaration shall remain unchanged.

[Signatures on next page]

IN WITNESS WHEREOF, the said VH CC, LLC, a Wisconsin Limited Liability Company has caused these presents to be signed and sealed this 17 day of December, 2021.

VH CC, LLC  
By: VH Holdings, LLC, Its Sole Member

By:   
Chris Ehlers, Authorized Signatory

STATE OF WISCONSIN    )  
  ) ss  
COUNTY OF DANE        )

Personally came before me this 17 day of December, 2021, Chris Ehlers the Authorized Signatory of VH CC, LLC a Wisconsin Limited Liability Company, to me know to be such persons and officers who executed the foregoing instrument and acknowledged that they executed the same as such officers, by its authority for the purposes therein contained.

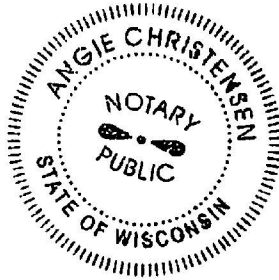

  
Notary Public  
Dane County, Wisconsin  
My Commission Expires: May 1, 2024

This document was drafted by:

Gregory J. Paradise  
Mohs Widder Paradise LLC  
20 North Carroll Street  
Madison, WI 53703

**CONSENT OF MORTGAGEE**

The undersigned, First Business Bank, hereby consents to the forgoing First Amendment to Declaration of Conditions, Covenants and Restrictions for the plat of Crescent Crossing. This consent does not limit, restrict or affect in any way Mortgagee's rights, interest and remedies regarding Mortgagee's interest in the Property.

Dated this 16<sup>th</sup> day of December, 2021.

**FIRST BUSINESS BANK**

By: 

Print Name: Brian E. Hagen

Print Title: Senior Vice President

STATE OF WISCONSIN    )  
  ) SS.  
COUNTY OF DANE        )

Personally came before me this 16<sup>th</sup> day of December, 2021, the above-named Brian E. Hagen to me known to be the person who executed the foregoing instrument and acknowledged that they executed the same for the purposes therein contained.

  
Notary Public, Dane County, WI  
My Commission Expires: OCT. 29, 2022



**Exhibit "A"**

**Description of Crescent Crossing**

**Lots 1-117 and Outlots 1-11, Crescent Crossing, located in the City of Fitchburg, Dane County,  
Wisconsin**

**Exhibit "A"**

Lot	PIN
1	0609-083-4001-2
2	0609-083-4012-2
3	0609-083-4023-2
4	0609-083-4034-2
5	0609-083-4045-2
6	0609-083-4056-2
7	0609-083-4067-2
8	0609-083-4078-2
9	0609-083-4089-2
10	0609-083-4100-2
11	0609-083-4111-2
12	0609-083-4122-2
13	0609-083-4133-2
14	0609-083-4144-2
15	0609-083-4155-2
16	0609-083-4166-2
17	0609-083-4177-2
18	0609-083-4188-2
19	0609-083-4199-2
20	0609-083-4210-2
21	0609-083-4221-2
22	0609-083-4232-2
23	0609-083-4243-2
24	0609-083-4254-2
25	0609-083-4265-2
26	0609-083-4276-2
27	0609-083-4287-2
28	0609-083-4298-2
29	0609-083-4309-2
30	0609-083-4320-2
31	0609-083-4331-2
32	0609-083-4342-2
33	0609-083-4353-2
34	0609-083-4364-2
35	0609-083-4375-2
36	0609-083-4386-2
37	0609-083-4397-2
38	0609-083-4408-2
39	0609-083-4419-2
40	0609-083-4430-2
41	0609-083-4441-2
42	0609-083-4452-2
43	0609-083-4463-2
44	0609-083-4474-2
45	0609-083-4485-2

Lot	PIN
46	0609-083-4496-2
47	0609-083-4507-2
48	0609-083-4518-2
49	0609-083-4529-2
50	0609-083-4540-2
51	0609-083-4551-2
52	0609-083-4562-2
53	0609-083-4573-2
54	0609-083-4584-2
55	0609-083-4595-2
56	0609-083-4606-2
57	0609-083-4617-2
58	0609-083-4628-2
59	0609-083-4639-2
60	0609-083-4650-2
61	0609-083-4661-2
62	0609-083-4672-2
63	0609-083-4683-2
64	0609-083-4694-2
65	0609-083-4705-2
66	0609-083-4716-2
67	0609-083-4727-2
68	0609-083-4738-2
69	0609-083-4749-2
70	0609-083-4760-2
71	0609-083-4771-2
72	0609-083-4782-2
73	0609-083-4793-2
74	0609-083-4804-2
75	0609-083-4815-2
76	0609-083-4826-2
77	0609-083-4837-2
78	0609-083-4848-2
79	0609-083-4859-2
80	0609-083-4870-2
81	0609-083-4881-2
82	0609-083-4892-2
83	0609-083-4903-2
84	0609-083-4914-2
85	0609-083-4925-2
86	0609-083-4936-2
87	0609-083-4947-2
88	0609-083-4958-2
89	0609-083-4969-2
90	0609-083-4980-2

Lot	PIN
91	0609-083-4991-2
92	0609-083-5002-2
93	0609-083-5013-2
94	0609-083-5024-2
95	0609-083-5035-2
96	0609-083-5046-2
97	0609-083-5057-2
98	0609-083-5068-2
99	0609-083-5079-2
100	0609-083-5090-2
101	0609-083-5101-2
102	0609-083-5112-2
103	0609-083-5123-2
104	0609-083-5134-2
105	0609-083-5145-2
106	0609-083-5156-2
107	0609-083-5167-2
108	0609-083-5178-2
109	0609-083-5189-2
110	0609-083-5200-2
111	0609-083-5211-2
112	0609-083-5222-2
113	0609-083-5233-2
114	0609-083-5244-2
115	0609-083-5255-2
116	0609-083-5266-2
117	0609-083-5277-2
OUTLOT 1	0609-083-5300-2
OUTLOT 2	0609-083-5325-2
OUTLOT 3	0609-083-5350-2
OUTLOT 4	0609-083-5375-2
OUTLOT 5	0609-083-5400-2
OUTLOT 6	0609-083-5425-2
OUTLOT 7	0609-083-5450-2
OUTLOT 8	0609-083-5475-2
OUTLOT 9	0609-083-5500-2
OUTLOT 10	0609-083-5525-2
OUTLOT 11	0609-083-5550-2

KRISTI CHLEBOWSKI  
DANE COUNTY  
REGISTER OF DEEDS

DOCUMENT #  
5690539  
02/02/2021 11:48 AM  
Trans Fee:  
Exempt #:  
Rec. Fee: 30.00  
Pages: 36

\*\*The above recording information  
verifies that this document has  
been electronically recorded and  
returned to the submitter.\*\*

Document No.

**CRESCENT CROSSING  
DECLARATION OF PROTECTIVE COVENANTS,  
CONDITIONS AND RESTRICTIONS**

**CITY OF FITCHBURG, DANE COUNTY, WI.**

Return to:  
Angie Christensen  
Veridian Homes  
6801 South Towne Drive  
Madison, WI53713

**PREAMBLE**

See Exhibit "A"  
(Parcel Identification Numbers)

This Declaration of Protective Covenants, Conditions and Restrictions (the "**Declaration**") is made this 21 day of January, 2021 by VH CC, LLC, a Wisconsin Limited Liability Company (hereinafter referred to as the "**Declarant**") and/or its successors and assigns.

**WHEREAS**, Declarant is the owner of certain real property located in the plat of Crescent Crossing (the "Plat") located in the City of Fitchburg, Dane County, Wisconsin. The Lots are more particularly described in Exhibit "A" attached hereto and incorporated herein by reference, and the Plat is shown in Exhibit "B", attached hereto and incorporated herein by reference; and

**WHEREAS**, by this Declaration, Declarant subjects the Lots and Outlots to the terms hereof, so that the Lots and Outlots will be constructed as a planned development with housing units and shared common property (the "Development"; and

**WHEREAS**, Declarant desires to provide for the maintenance and enhancement of property values and amenities in said Development, and for the preservation of the properties and improvements thereon, as well as, for the preservation of said Development's distinctive style, and to prevent the erection, or maintenance of poorly designed or constructed improvements; and

**WHEREAS**, to the above end, Declarant desires to subject the Development to the covenants, restrictions, easements, charges and liens hereinafter set forth, each and all of which is and are for the benefit of said property and each owner thereof; and

**WHEREAS**, Declarant has thought it desirable for the efficient maintenance and preservation of the values of said Development to create an Association to which should be delegated and assigned the powers of owning, maintaining and administering the Common Property and facilities, as set forth below, and administering and enforcing the covenants and restrictions, and collecting and disbursing the Assessments and charges as hereinafter or in the future created or established, and promoting the health, welfare and recreation of the Development's residents, and to that end Declarant has incorporated the Crescent Crossing Homeowners Association, Inc. a non-profit, non-stock corporation, under the laws of the State of Wisconsin (the "**Association**"); and **NOW, THEREFORE**, the Declarant declares that the real property constituting the Development will and shall be sold, transferred and conveyed subject to the easements, covenants, restrictions, assessments, charges and liens hereinafter set forth.

**PART A**  
**ASSOCIATION MATTERS**

**A-1) Definitions.**

**A)** "Association" shall mean and refer to the Crescent Crossing Homeowners Association, Inc., and its successors and assigns.

**B)** "Common Property" includes all those areas located in the Development which are not contained within a Lot and which are intended for common use or are necessary or convenient to the existence, maintenance or safety of the Development. Common Property may also include any additions thereto designated by the Declarant or the Association in any subsequent amendment to this Declaration, and all improvements located on said property, which are intended to be devoted to the common use and enjoyment of members, Owners and Occupants. Common Property shall further include all public or private alleys (if any), access ways, traffic calming measures, plantings, landscaping islands or boulevards, which the City of Fitchburg is not obligated to maintain. Declarant may, by subsequent amendment or easement, designate parts of certain private lands within the Development as Common Property, rendering the Association responsible for maintenance thereof, without subjecting the same to the ownership provisions contained in Section A-3, below.

**C)** "Declarant" shall mean and refer to VH CC, LLC, a Wisconsin Limited Liability Company, and/or its successors and assigns.

**D)** "Lot" shall mean and refer to the individual subdivided single family lots in Crescent Crossing as described and depicted in Exhibit "A", now owned by Declarant, but which Declarant in the future intends to convey to purchasers who shall thereupon become members of the Association. The term "Property" or "Properties" shall be synonymous with the term Lot.

**E)** "Owner" shall mean and refer to the record owner, whether one or more persons or entities, of the fee simple title to any of the Properties described in Exhibit "A". A purchaser of any of said Properties by land contract shall be referred to as "Owner" instead of the land contract vendor.

**F)** "Occupant" shall mean and refer to the occupant of any of the Properties who shall either be an Owner or a lessee who holds a written lease having an initial term of twelve months or more.

G) "Subdivision" shall refer to the lands described in Exhibit "A". The term "Subdivision" is synonymous with the term "Development".

H) "City" shall refer to the City of Fitchburg, a Wisconsin Municipal Corporation.

**A-2) Membership and Voting Rights.**

A) **Members.** Declarant has incorporated the Association. The Association shall have two classes of membership. Each Owner of a Lot shall automatically become a Class A Member of the Association. The Declarant, or its successors or assigns, is the Class B Member of the Association. Declarant shall not be considered a Class A Member in the Association notwithstanding its ownership of Lots in the Subdivision. By acceptance of the Deed or other instrument of conveyance, the Owner(s) of each Lot consent to such Owner's membership in the Association whether or not specified on the deed to the Owner. A Class A membership in the Association is appurtenant to each Lot. Each Owner of a Lot shall automatically be entitled to the benefits and subject to the burdens relating to such Class A membership in the Association. The Association shall have authority to manage the Common Property. Persons or entities, including a land contract vendor, who hold an interest merely as security for the performance of an obligation, shall not be members of the Association. Tenants of Properties who are not Owners shall not be members of the Association. The rights, duties and obligations of the Class A and the Class B Members are specified in this Declaration and in the By-Laws of the Association.

B) **Articles of Incorporation and By-Laws.** The purposes and powers of the Association and the rights and obligations with respect to the members thereof, shall be governed by the Articles of Incorporation and By-Laws of the Association; provided, however, that such Articles of Incorporation and By-Laws shall be subject to, and shall not contravene, the terms, conditions, benefits and burdens set forth in this Declaration.

C) **Class B Member Obligation for Assessments.** Declarant has no responsibility to pay for operating expenses of the Association by virtue of its ownership of the Class B membership interest in the Association. Declarant's liability for operating expenses is limited by and subject to the provisions of this Declaration.

D) **Calculation of Assessments.** The Association shall calculate an Owner's responsibility for assessments based on the following formula:

Total Subdivision Expenses/Total Number of Assessment Units X Assessment Unit(s) of Lot in question.

As used above, the term "Total Subdivision Expenses" shall mean (i) all Common Area Expenses which the Association estimates actually incurring during the budget year in question, plus (ii) all Common Area Expenses which the Association estimates it would incur during the budget year in question if all phases of the Subdivision were completed at the time said calculation is made. Declarant shall not be responsible for assessments on Declarant owned Lots. Declarant shall be responsible for paying to the Association the amount by which the Assessments collected by the Association are less than the amount necessary to pay for all actual Common Area Expenses incurred by the Association for the budget year in question until such time as Declarant owns 5% or less of the lots in the subdivision or control of the Association is turned over to the Owners, whichever occurs first.

**A-3) Description.**

**A) Responsibility for Assessments.** The following table describes the number of assessment units (an "Assessment Unit"), which are assigned to various Lots in the Development based upon their intended use at the present time. For the purposes of the following table, a single family residence shall be deemed a Dwelling Unit.

<u>Use</u>	<u>Number of Assessment Units</u>
1) Single Family:	One (1) per Dwelling Unit.
2) Twin Homes (2 unit attached residential)	One (1) per Dwelling Unit (each side defined as a dwelling unit)

**B) Association Management.** The Association is required to retain a professional property management company with the experience necessary to perform the duties of the Association (the "Management Company"). The Association shall enter into a management contract (the "Management Contract") with the Management Company on such terms and conditions as the Association and the Management Company shall agree. The initial Management Company is DSI Real Estate Group, Inc., a Wisconsin Corporation, which is affiliated with the Declarant by reason of common ownership. The Management Contract between DSI Real Estate Group, Inc. and the Association has not been negotiated on an arm's length basis.

**C) General Fund.** As used herein, the term "Surplus" shall mean the amount by which assessments collected by the Management Company on behalf of the Association to pay for common expenses relating to the Property exceed the common expenses for the fiscal year in question. The Management Company shall deposit and hold any Surplus in the Association's operating account maintained by the Management Company. The Surplus, in the discretion of the Association working in conjunction with the Management Company, may be applied to future Association expenses as they become due, but there shall be no obligation on either the Association's or the Management Company's part to return the Surplus to lot owners.

**D) Declarant's Responsibility for Assessments.** Declarant shall not be responsible for assessments on Declarant owned Lots. Declarant shall be responsible for paying to the Association the amount by which the Assessments collected by the Association are less than the amount necessary to pay for all actual Common Area Expenses incurred by the Association for the budget year in question.

**E) Percentage Interest for Condemnation or Insurance Proceeds.** For the purposes of establishing an Owner's percentage of insurance proceeds or condemnation awards in the event any portion of the Common Property is completely destroyed or taken by eminent domain and is not reconstructed, each Owner shall have a percentage interest in the insurance or condemnation proceeds equal to the Percentage Interest of such Owner in the Common Property. "Percentage Interest" shall be calculated as follows: the number of Assessment Units for a particular Lot will be divided by the total number of Assessment Units in the Development to arrive at a particular Lot's percentage share (the "Percentage Interest" of assessments for common area maintenance and other expenses, which the Association is permitted to assess to Class A Members under the Declaration.

**F) Conveyance, Lease or Encumbrance of Percentage Interest.** Any deed, mortgage, lease or other instrument purporting to convey, encumber or lease for a period of time in excess of one (1) year (a "Lease") any Lot shall be deemed to include the Owner's Percentage Interest in the Common Property and in the insurance proceeds or condemnation awards even though such interest is not expressly described or referred to therein. The conveyance, encumbrance or Lease of an Owner's Percentage Interest in the

Common Property independent of the appurtenant Lot and the conveyance, encumbrance or Lease of an appurtenant Lot independent of the Owner's Percentage Interest in the Common Property shall be prohibited.

**G) Ownership.**

1) The Common Property shall be initially owned by the Declarant until conveyed as provided below.

2) At the time of purchase, legal title to a percentage interest in the Common Property shall be deemed conveyed with each lot to an Owner, whether or not specified on the deed to the Owner. Legal title to the percentage interest in the Common Property shall be deemed conveyed with any subsequent conveyance of a Lot whether or not specifically stated. Taxes, assessments or other charges on the Common Property may be divided according to each Owner's Percentage Interest by the taxing authority or may be an assessment by the Association against each of the Lots in an amount equal to the Percentage Interest attributable to such Lot.

3) The Common Property shall be conveyed to the Association by the Declarant. The Association shall be responsible for the payment of any and all present and future general taxes, assessments or other charges against any portion of the Common Property owned by the Association.

**H) Damage or Destruction of Common Property by Owner.** In the event any Common Property is damaged or destroyed by an Owner or any of his guests, lessees, tenants, licensees, agents or member(s) of his family, including pets, said Owner does hereby irrevocably authorize the Association to repair said damage. The Association shall repair and restore any damaged area to its former condition. The amount necessary for said repair shall become a special assessment upon the Property of said Owner.

**A-4) Maintenance of Common Property**

**A) Maintenance Requirements.**

1) **Responsible Party.** Declarant shall initially provide for the care, operation, management, maintenance and repair of the Common Property, until the Common Property is conveyed as provided herein. After such time, the Association shall provide for the care, operation, management, maintenance and repair of the Common Property and shall keep the Common Property maintained in good and safe condition.

2) **General Responsibilities.** Maintenance shall include, but not be limited to, responsibility for landscaping and lawn care, trash removal in the alleyways, snow removal including shoveling with particular attention being paid to cross walk ramps and islands, improvements to common areas, upkeep of stormwater management facilities which may include detention basins and drainage swales, common property lighting and/or other common property utility charges and any special street design features or traffic calming features.

3) **Specific Responsibilities.** Certain streets within the Property may include special traffic islands and traffic calming measures within the public right-of-way. The Association shall be responsible, at the Association's sole cost and expense, for the maintenance and upkeep of such physical traffic measures. Such maintenance and upkeep shall be performed at the discretion of the Association except to the extent required by the City, and shall include landscaping, snow and ice removal.

If the special street design features or landscaping are not maintained, the City will give notice to the Association that it is not being maintained. If the Association does not respond to the notice within sixty (60) days, the City may modify the physical traffic measures to minimize maintenance needs; including replacing landscaped surfaces with asphalt. The Association and persons involved with the maintenance and upkeep of the special traffic measures shall indemnify and hold harmless the City and its boards and commissions, and their officers, agents and employees from and against all claims, demands, loss or liability of any kind, type or description, related to the maintenance and upkeep of the special traffic measures.

4) Any and all expenses incurred by the Declarant, or by the Management Company, on behalf of and pursuant to its contract with the Association, in connection with the management and maintenance of the Common Property and administration of the Association shall be deemed to be common expenses (“**Common Expenses**”), including, without limitation, expenses incurred for: landscaping and lawn care; snow shoveling and plowing; trash removal in alleyways; improvements to the Common Property; common grounds security lighting; municipal utility services for Common Property enforcement of this Declaration (including attorneys’ fees); and maintenance and management salaries and wages.

**B) Maintenance and Conditions of Private Alleys**

1) All maintenance, replacement and repairs for Outlots 1 and 8-10 shall be the responsibility and obligation of the Declarant until conveyed to the Association, at which time the Association shall assume responsibility.

The obligation for maintenance, replacement and repairs of the aforesaid Outlots shall include, without limitation:

- a) Maintaining the alleyways in good order and repair, with the type of surfacing materials originally installed or such substitute as shall in all respects be equal in quality, use and durability; and
- b) Removing all litter, ice and snow, mud and sand, debris and refuse, and sweeping the surfaces to the extent reasonably necessary to keep the surfaces in a reasonably clean condition; and
- c) Paying for the real estate taxes and assessments and other governmental impositions related to the easements, and procuring and paying for such insurance for the easements as required herein.
- d) Maintaining certain public and private improvements and facilities which are the subject of certain agreements placed of record by Declarant, which Declarant deems necessary for the development of the Subdivision and the use and enjoyment thereof by the Lot Owners. The obligations of Declarant under the terms of such agreements will be binding on the Association

**C) Assessments.**

1) The Association, or the Management Company, on its behalf, shall levy annual general assessments (“**General Assessments**”) against each Lot beginning January 1 of every year for the purpose of maintaining a fund from which Common Expenses may be paid. The General Assessments against each Lot shall be assessed according to their Percentage Interests in the Common Property. General

Assessments shall be due in advance on the first day of each year, or in such other manner as the Association may set forth in the Bylaws. Any General Assessment not paid when due shall bear annual interest at a rate of ten percent (10%) until paid and, together with interest, collection costs, and reasonable attorneys' fees, shall constitute a lien on the Lot on which it is assessed.

2) The Association, or the Management Company, on behalf of and pursuant to its contract with the Association, may, whenever necessary or appropriate, levy special assessments ("**Special Assessments**") against the Lots for deficiencies in the case of destruction or condemnation, for defraying the cost of improvements to the Common Property or for any other purpose for which the Association and/or the Management Company may determine a Special Assessment is necessary or appropriate for the improvement or benefit of the Subdivision. In addition, the Association shall have the authority to levy Special Assessments against one or more of the Lots, but less than all, in cases where the Association incurs expenses that are attributable to the act or failure to act by one or more Lot Owners in violation of this Declaration, the Articles of Incorporation, By-laws or rules of the Association in effect from time to time. Special Assessments may also be imposed by the Association for failure to pay any Fines levied against an Owner pursuant to the provisions of Section E-2, below. Special Assessments shall be paid at such time and in such manner as the Association or the Management Company may determine. Any Special Assessment or installment not paid when due shall bear annual interest at a rate of ten percent (10%) until paid and, together with the interest, collection costs and reasonable attorneys' fees, shall constitute a lien on the Lot on which it is assessed.

3) The Association, or the Management Company, on behalf of and pursuant to its contract with the Association, shall have the right to collect all General and Special Assessments and such sums shall constitute a lien on the Lot or Lots against which the Assessment is made. The Owner of a Lot, or any portion thereof, shall be personally obligated to pay such charges which were assessed or accrued upon the land owned during the period of Ownership. The Association or the Management Company, on behalf of and pursuant to its contract with the Association, may commence an action against any Owner personally obligated to pay the charges or to foreclose the lien for such charge against any Lots. Any such foreclosure action may be brought at the Association's election, either in the same manner as an action to foreclose a real estate mortgage, or as a proceeding to enforce a statutory maintenance lien as provided in Section 779.70, Wis. Stats., to the extent said Section is applicable. Any lien in favor of the Association/Management Company securing unpaid charges arising by virtue of this Declaration shall be subject and subordinate to the lien of any mortgage whether the mortgage is executed or recorded prior to or after the creation of such lien.

D) **Subordination of the Lien to Mortgages.** The lien of the assessments provided for herein shall be subordinate to the lien of any first mortgage. Sale or transfer of any Property shall not release the assessment lien. However, the sale or transfer of any Property pursuant to mortgage foreclosure or any proceeding in lieu thereof shall extinguish the lien of such assessment(s) as to payments which become due prior to such sale or transfer. No sale or transfer pursuant to foreclosure or proceedings in lieu thereof shall relieve such Property from liability from any assessments thereafter becoming due or from the lien thereof.

E) **Joint and Several Liabilities of Grantor and Grantee.** Upon a voluntary conveyance, the grantee of a Property shall be jointly and severally liable with the grantor for all unpaid assessments against the grantor as provided in this Declaration up to the time of conveyance, without prejudice to the grantee's right to recover from the grantor the amount paid by the grantee therefore. However, any such grantee shall be entitled to a statement from the Association setting forth the amount of such unpaid assessment and any such grantee shall not be liable for, nor shall the Property conveyed be subject to a lien for, any unpaid assessments against the grantor pursuant to this Declaration in excess of the amount therein set forth.

**PART B**  
**CONDITIONS, COVENANTS AND RESTRICTIONS**

**B-1) Applicability.** The following provisions in this Part B shall apply to all Lots as described in Exhibit "A" and such other Lots as may, in the future, be acquired by Declarant and subjected to this Declaration, as the same may be amended from time to time, by Declarant in the sole exercise of Declarant's discretion. Uses, other than the uses set forth in this Part B, shall not be permitted on the Lots or Outlots, as applicable, without the prior written approval of the Declarant and Committee (defined in Section C-2 below), as appropriate. After Declarant control of the Association has terminated, approval from the Association and the Committee shall be required.

**B-2) Land Use And Building Type.** Only the following designated uses for Lots shall be permitted:

**A)** Lots 1-19, 54-90 and 109-117 shall be used for single family residential purposes. No building shall be erected, altered, placed or permitted to remain on any Lot other than one detached single family dwelling unit not to exceed two and one-half stories in height. Each dwelling unit shall have an attached or detached garage of a size to be approved by the Committee, as that term is defined below. The size of a dwelling unit to be constructed on specific Lots shall not be less than the minimum size to be established hereinafter.

**B)** Lots 20-53 and 91-108 shall be used as 2-unit attached residential.

**C)** Outlots 1 and 8-10 shall be used for private Alley and utility easement purposes for the benefit of lots 1-117. Private alley shall be maintained by the Association. Parking in the private alley is prohibited, unless where parking spaces are designated.

**D)** Outlot 2 is proposed public pedestrian path and water main easement located in Outlot 3 and proposed to be dedicated to the public for pedestrian path and water main purposes adjacent to Lots 18 and 19.

**E)** Outlots 4, 6 and 11 shall be dedicated to private open space.

**F)** Outlots 3 and 5 shall be dedicated to the public for stormwater management purposes.

**G)** Outlot 7 and a portion of Outlot 11, shall be used for the purposes of a public park (to be located on Outlot 7) and a dog park (to be located on a part of Outlot 11). The public park shall be herein referred to as the "**People's Park**" and the dog park shall be herein referred to as the "**Dog Park**," and collectively with the People's Park the "**Parks**". Declarant, with the consent of the City, will cause to be recorded a Restrictive Covenant which by its terms will require that the Outlots, or the applicable portion thereof, be used for purposes of the People's Park and the Dog Park as follows:

1) Declarant shall construct certain improvements in the Parks at its expense in accordance with plans approved by the City, which improvements are more particularly described in the Restrictive Covenant.

2) At all times after construction of the improvements are completed and accepted by the City, the Parks shall be free and open to the general public and shall not be restricted to

use only by owners of Lots in the Subdivision. The foregoing shall not be construed as permitting any use of the Parks that is a nuisance, or is lewd, unlawful or illegal, or which unduly disturbs the Owners and occupants of Lots in the Subdivision.

3) The use of the Dog Park is at all times subject to the rules promulgated by the City for City owned dog parks, as the same may be amended from time to time.

4) The Association, shall be responsible for and shall pay the cost of inspecting and maintaining the Parks in accordance with the maintenance standards commonly used by the City to maintain public parks owned by the City of like size and use. To the extent necessary or required in order to permit the City to perform inspection of the Parks, the City will be given a permanent, non-exclusive easement to enter upon any part of the Parks for the purpose of undertaking inspection.

5) In the event that prior to the Turnover Date the Responsible Party shall fail to maintain the Parks as required (a “**Default**”), then the City may perform such maintenance and assess the cost thereof to Declarant, or at its option, each fee Owner of a Lot in the Subdivision as a special assessment or in any other manner as may be permitted under applicable law, provided, however, that the City first gives the Responsible Party written notice of the Default and a period of time, to be not less than thirty (30) days, to cure the Default. Said notice of Default shall specify the action which the City believes the Responsible Party must take in order to cure the Default. In the event the Default is of a kind which reasonably takes in excess of thirty (30) days to cure, or if the Default cannot be cured on account of inclement weather or other act of force majeure, then the Responsible Party shall have a reasonable period of time to cure the Default under all of the facts and circumstances then existing, provided the Responsible Party takes steps to cure the Default promptly after notice or after expiration of the event of force majeure. If the Default shall create an emergency, then the City shall only be obligated to give such notice as is practical under the facts and circumstances then existing and may take immediate steps to address the problem which created the emergency. As used herein, the term “emergency” shall mean an occurrence which the City reasonably determines poses an immediate, material and substantial threat of loss of life or property.

6) Prior to the Turnover Date the Responsible Party shall be required to maintain with respect to the Parks at its expense certain insurance coverages more particularly described in the Restrictive Covenant. The City shall be named as an additional insured on all such policies. The policies shall provide that it may not be cancelled or non-renewed except upon not less than thirty (30) days written notice to the Responsible Party and the City.

7) The Restrictive Covenant may only be amended or terminated by a written agreement executed by the then fee owner of the Parks and by the City. Any such amendment or termination shall be effective on the date such document is recorded in the office of the Dane County, Wisconsin Register of Deeds.

Uses, other than the uses set forth in this section B-2, shall not be permitted on the Lots, as applicable, without the prior written approval of the Declarant and Committee (defined in Section B-3 below), as appropriate. After Declarant control of the Association has terminated, approval from the Association and the Committee shall be required.

Except as otherwise provided herein, no buildings, signs or other structures incidental to the use of any Outlot, which have not been approved in advance by the Committee, may be constructed on any Outlot.

The Plat shows the streets and rights of ways which are to be dedicated as permanent public streets and

rights-of-way and which shall be improved in accordance with agreements entered into between the Declarant and the municipality in which the Development is located.

**B-3) Architectural Control.** No building shall be erected, placed or altered on any Lot until the construction plans and specifications and a plan showing the location of the structure have been approved by a majority of the Architectural Control Committee (the “Committee”) as to quality of workmanship and materials, harmony of external design with existing structures, and as to location with respect to topography and finish grade elevation. There shall be a variation in building elevations on adjacent Lots. Approval shall be as provided below.

**B-4) Dwellings and Landscaping.** The landscaping to be installed on all Lots must meet or exceed the minimum number of points for foundation planting and cumulative total landscaping points, including foundation planting points as set forth hereafter as described in Exhibit “C”, attached hereto and incorporated herein by reference. The number of points attributable to various elements of the landscaping to be installed shall be determined by reference to Exhibit “D”, attached hereto and incorporated herein by reference and further referenced in the Design Guidelines. The structure and the minimum landscaping requirements shall be completed within nine (9) months after issuance of a building permit. Landscaping installed by the Declarant may or may not meet the minimum number of required points. All driveways shall be of concrete and shall be installed within nine (9) months after substantial completion of the structure. No outbuilding or accessory building of any nature shall be erected on any Lot with the exception of detached garages approved by the Committee in advance of construction. No above-ground swimming pools shall be permitted. All Lot areas not used as a building site, or under cultivation as a family garden, shall be planted with grass seed or shall be sodded, and shall be maintained on a regular seasonal basis, including mowing of a frequency of not less than once every fourteen (14) days during the lawn growing season. Maintenance of all improvements on a Lot shall be performed by the Owner. Maintenance shall include, but not be limited to, watering, pruning and routine fertilizing and mulching of all plantings and plant beds, replacement of dead, dying and/or diseased trees and shrubs, prompt removal of weeds, trash and debris from plant beds and areas adjacent to shrubs and trees so as to keep said landscaping in a healthy, attractive and neat condition.

If the Owner of any Lot, after reasonable notice, fails or refuses to install landscaping as described herein, or maintain it as required above, the Committee, through its duly authorized agents or employees, shall have the right to enter upon said Lot at reasonable hours to perform said landscaping and/or maintenance. The costs of the materials and labor to perform such landscaping and/or maintenance shall be assessed against said Lot in accordance with the terms of Section A-4 (C)(2) above, which assessment may be foreclosed or collected in accordance with the terms hereof or collected as provided herein.

**B-5) Vehicle and/or Equipment Storage.** No inoperable, dilapidated or junk vehicles of any nature may be kept upon any Lot except in a fully enclosed garage. The exterior storage of boats, trailers, travel trailers, campers, motorcycles, recreational vehicles, automobiles or trucks, portable moving and storage containers, mini storage or on-site storage containers (collectively, without limitation by reason of enumeration “Equipment”), of any nature is prohibited whether or not screened from public view. No Equipment shall be parked or stored on lawns. The temporary storage of vehicles in a drive area for the purpose of loading or unloading for a period not to exceed twelve (12) hours is permitted. No commercial vehicles, including trucks, semi-trailers, trailers, may be stored or parked overnight on or in front of said Lots except in an enclosed garage

**B-6) Construction On Adjoining Lots.** Nothing contained herein shall be construed to prohibit the construction of a residential dwelling or private garage partially on one Lot and partially on an

adjoining Lot without regard to side yards between adjoining Lots, provided that all such Lots are owned by the same person or persons.

**B-7) Easements.**

**A)** No structure, planting, or other materials shall be placed or permitted to remain within any easement of record (an "**Easement**") if any, which may damage or interfere with the installation and maintenance of utilities, or which may change, obstruct or retard the flow of water or the direction of such flow through the Easement or through such other drainage channels or swales that may have been created by the Plat or otherwise. The Easements located on each Lot and all improvements therein shall be maintained continuously by the owner of the Lot, except for those improvements for which a public authority or utility company is responsible.

**B)** The Intra-block drainage Easement shall be graded with the construction of each principal structure in accordance with the approved Stormwater Drainage Plan on file with the City Engineer and the Zoning Administration, as amended in accordance with the Fitchburg General Ordinances.

**C)** Public utility easements as set forth on the Plat are for the use of public and private utilities having the right-of-way to serve the area.

**D) Temporary Construction Easement.** Each Lot which has been made subject to this Declaration (for the purposes of this paragraph each Lot described herein shall be referred to as the "**Primary Lot**") is hereby made subject to a temporary, non-exclusive easement over, under, upon, across and through so much of the side yards of the Primary Lot as may be necessary for the safe and code compliant construction of a basement, including but not limited to footings, foundation and basement walls, on the adjoining Lot (the "**Adjoining Lot**"). The purpose of this Temporary Construction Easement is to permit Declarant to adequately slope and provide lateral support to the walls of the basement excavation in question so as to protect against cave-ins and loss of lateral support, and it shall be broadly construed to effectuate such purpose. This Temporary Construction Easement shall remain in effect for so long as it is needed to permit construction of the basement on the Adjoining Lot in a safe and code compliant manner. After completion, Declarant shall backfill the excavated area, compact such backfill in accordance with good construction practices, and restore the area affected by this easement to the condition existing immediately preceding the excavation, including replacement of sod, trees, shrubs and other landscaping, at no expense to the Owner of the Adjoining Lot (collectively "**Restoration**"). This Temporary Construction Easement shall, without further notice, terminate upon completion of said Restoration." This Temporary Construction Easement shall, without further notice, terminate upon completion of said Restoration.

**E) Multi-User Mailboxes Easement.** Based on new, recently adopted requirements of the United States Postal Service, this neighborhood will receive mail by using CBU's (cluster box units) instead of curb side mailboxes on newly constructed homesites. These new requirements will phase out curb side mailboxes nationwide solely at the Postal Service's discretion. Certain Lots will feature CBU's and will be determined by phase as constructed and will be noted in the Neighborhood Disclosure Addendum A to be received by Buyer at the time a Sales Contract is signed. There will be a recorded Multi-User Mailbox Easement for such Lots. All maintenance (concrete pad repair and replacement, CBU and snow removal around the CBU) shall be the sole responsibility of the Association.

**F)** Lots 1-19, 54-90 and 109-117 shall be subject to a Declaration of Sideyard Easements by separate, recorded document.

G) Lots 54-58 shall have a ten foot (10') wide public sidewalk easement along the front property line adjacent to Outlot 7 and shall be maintained by the Association.

H) Lots 54-58 shall have a thirty foot (30') wide public sanitary sewer and water easement along the front property line adjacent to Outlot 7 and shall be maintained by the City.

I) Outlots 3 and 11 shall have a one hundred foot (100') wide American Transmission Company (ATC) easement. We advise all property owners to familiarize themselves with the poles and voltage by reviewing information at [www.atcllc.com](http://www.atcllc.com).

J) Outlot 4 shall have a thirty foot (30') wide public water and sanitary sewer easement.

K) Outlots 4-5 and a portion of Outlot 10 shall have a six foot (6') wide Ameritech Easement.

L) Outlot 6 shall have a fifteen foot (15') wide public storm sewer easement. The Outlot shall be maintained by the Association and the storm sewer easement shall be maintained by the City.

M) A portion of Outlot 11 shall have a twenty foot (20') wide public pedestrian and bike path easement.

N) A portion of Outlot 11 shall have a twenty-six foot (26') wide public water main and sanitary sewer easement which shall be maintained by the City.

**B-8) Slope and Swale Areas.**

A) The graded slopes and swales as established by Declarant shall remain as permanent. Within these slopes and swales, no structure, planting or other material shall be placed or permitted to remain, or other activities undertaken which may damage or interfere with established slope and swale ratios, create erosion or sliding problems or which may change the direction of flow of drainage channels or obstruct or retard the flow of water through drainage channels. The slopes and swales of each Lot and all improvements in them shall be maintained continuously by the Owner of a Lot, at the Owner's sole expense, except for those improvements for which a public authority or utility company is responsible.

B) In order to control run off, all down spouts and down spout extenders are to drain into a permeable area such as grass or a planting bed.

C) Declarant and the City have agreed to a certain Storm Water Management Plan. In the event of conflict between any plans and such Storm Water Management Plan, the Storm Water Management Plan shall control. Declarant and the Association shall each have the right to enter upon any Lot at any time for the purpose of inspection, maintenance or correction of any drainage condition and the Lot Owner shall be responsible for the cost thereof.

D) Any disputes relating to drainage swales, drainage or other surface water issues, shall be resolved by the Board of Directors of the Association, which may seek the advice of the City Engineer of the City. The Association shall establish procedures by which such decisions can be heard by the Board of Directors and decided by said Board.

**B-9) Nuisances.** No noxious or offensive activity shall be carried on upon any Lot, nor shall anything be done thereon which may be or may become an annoyance or nuisance to the neighborhood or which may have a detrimental effect on the value of other Lots and/or improvements.

**B-10) Temporary Structures.** No structure of a temporary character, trailer, basement, tent, shack, garage, barn or other outbuilding shall be used on any Lot at any time as a residence, either temporarily or permanently.

**B-11) Signs.** No sign of any kind shall be displayed to the public view on any Lot except, one professional sign of not more than one square foot, one sign of not more than six square feet advertising the property for sale or rent or signs without regard to size used by the Declarant, a builder or licensed real estate broker to advertise the property during the construction and sales period or to identify the subdivision and/or its Declarant. No signs will be located in the Outlots.

**B-12) Animals.** No animals, livestock or poultry of any kind shall be raised, bred or kept on any Lot, except that dogs, cats or other household pets may be kept, provided that they are not kept, bred or maintained for any commercial purpose. No animal enclosure, house, pen or fences or similar device shall be placed on any Lot without the prior written approval of the Committee which may require special landscaping and screening.

**B-13) Garbage and Refuse Disposal.** No Lot shall be used or maintained as a dumping ground for rubbish. Trash, garbage or other waste shall not be kept except in sanitary containers. No incinerators shall be permitted. Other equipment for the storage or disposal of such material shall be kept in a clean and sanitary condition. No trash, building materials, debris, leaves, lawn clippings, rocks or earth shall be placed in any Outlot.

**B-14) Sight Distance at Intersections.** No fence, wall, hedge or shrub planting which obstructs sight lines at elevations between 30" and 72" above the roadways shall be placed or permitted to remain on any corner Lot within the triangular area formed by the street property lines and a line connecting them at points twenty five (25) feet from the intersection of the street lines, or in the case of a rounded property corner, from the intersection of the street property lines extended. The same sight-line limitations shall apply on any Lot within ten (10) feet from the intersection of a street property line with the edge of a driveway or alley pavement. No tree shall be permitted to remain within such distances of such intersections unless the foliage line is maintained at sufficient height to prevent obstruction of such sight lines.

**B-15) Telephone (Land Line Service).** Due to updated FCC government regulations, telephone communication providers are no longer required to provide land line service to new phases. As a result, Declarant cannot guarantee that all new phases will have access to traditional land line phones. However, most of the cable company service providers have the ability to bundle in those services.

**B-16) Notices to Owners.** The following information is being put of record in order to give record notice to all Owners, mortgagees and other persons and entities having an interest in the Property:

A) Outlots 1 and 8-10 are alleyways intended to serve adjoining Lots for access and other lawful purposes. Restrictions on Outlots 1 and 8-10 are summarized as follows:

1) There will be no public trash, leaf or recycled material pick-up service in said Outlots, but instead, there will be one or more trash pick-up collection points designated by the Declarant to be used by Owners of a Lot bordering the Outlot in question. Trash pick-up may initially be

provided by the Association and charged as an expense of the Association, but such arrangement may be changed to provide for public or some other method of trash pick-up at a future time as determined by the Declarant or the Association. All trash receptacles to include recycling receptacles must be removed from the Outlots within 24 hours after trash or recycled material pick-up.

2) Snow removal, repair and replacement of Outlots will be the responsibility of the Association.

3) Homes with garage access to an Outlot are required to have two (2) "coach" lights on each side of the garage door, which will be wired to a photo electric eye for automatic use from dusk to dawn. The lights have been pre-selected by Declarant. There are four (4) selections available. It is the Buyer's responsibility to maintain the lights so that they are always operational.

4) After control of the Association is turned over by the Declarant to the Owners, the foregoing provisions of Section B-17 A) 1-3 shall not be amended, repealed, modified or changed without the advance, written consent of 75% of all Owners of Lots bordering any Alleys in the Subdivision, it being the intent of the Declarant that any change in the obligations of the Association with respect to the Alleys require the approval of a super majority of the Owners whose Lots border the Alleys and who benefit from the maintenance and services provided by the Association.

**B)** Plantings, flower beds, and entry signs (including utility installations connected therewith) constructed and installed by Declarant, if any, shall be deemed a part of the Common Area. The Association is obligated to maintain any entry feature; maintenance shall include electrical charges (if any), sign repair and maintenance of the landscaping including mowing of all lawns and grass areas. The cost of maintenance of said Common Property shall be an assessment against all of the Property in the subdivision in accordance with the Declaration, for so long as such maintenance is necessary or required adversely affects the natural flow of surface or underground waters with in the area permitted.

**B-18) Improvements Within Easements.** Any improvements (for example, fences, dog kennels, landscaping) located within any part of a Lot which is subject to a utility easement is subject to removal at the Owner's expense for utility maintenance and other reasons as determined by the party benefitted by the easement. Reinstallation of any improvement would be at the Owner's cost and would also be subject to the discretion of the party benefitted by the easement and is subject to terms and conditions as set forth on the final plat.

**B-19)** Lots 20-53 and 91-108 shall be subject to a Declaration of Party Wall Agreement. The Lots described are proposed twin homes which are two homes that share a party wall and roof with each other.

**B-20) *Lease Requirements.*** 1) An Owner may rent its dwelling by written Lease (a "Lease"), provided that

- a) The term of any such Lease shall not be less than six (6) months;
- b) The Owner has obtained the prior written approval of the Association to the proposed tenant and the terms of the proposed Lease, and the written approval for any proposed extension of the Lease; and

- c) The Lease contains a statement obligating all tenants to abide by this Declaration, the Articles, the Bylaws, and the Rules and Regulations, providing that the Lease is subject and subordinate to those instruments; and
- d) The Lease provides that any default arising out of the tenant's failure to abide by the Declaration, the Articles, the Bylaws, and the Rules and Regulations shall be enforceable by the Association as a third-party beneficiary to the Lease and that the Association shall have, in addition to all rights and remedies provided under the Declaration, the Articles, the Bylaws and the Rules and Regulations, the right to evict the tenant and/or terminate the Lease should any such violation continue for a period of ten (10) days following delivery of written notice to the Owner and the tenant specifying the violation.

2) *Standard for Approval of Lease and Tenant.* The Association may withhold approval on any reasonable basis, including, but not limited to: the failure of the Lease terms to comply with all provisions of this Declaration, the Articles, the Bylaws, and the Rules and Regulations; the past failure of the Owner, the tenant or tenant's guests to abide by all provisions of this Declaration, the Articles, the Bylaws, and the Rules and Regulations; and the past use by Owner, the tenant or its invitees or guests of any part of the Lot in a manner offensive or objectionable to the Association or other occupants of the Property by reason of noise, odors, vibrations, or nuisance.

### 3) *Violations / Remedies.*

a) During the term of any Lease of all or any part of a Lot, each Owner of such Lot shall remain liable for the compliance of the Lot, such Owner and all tenants of the Lot with all provisions of this Declaration, the Bylaws, and the Rules and Regulations of the Association, and shall be responsible for securing such compliance from the tenants of the Lot. The Association may require that a copy of each Lease of all or any part of a Lot be filed with the Association.

b) In the event that an Owner leases out its dwelling or any portion of its Lot in violation of this provision, the Association may impose a daily fine up to the greater of (i) an amount equal to the daily rental amount being charged by Owner to its tenant and (ii) \$100 (this daily fine shall be adjusted up every five years by 5%).

In addition to any fines imposed under this Section, the Owner shall reimburse the Association for all costs incurred by the Association, including attorneys' fees, incurred to enforce this Section, any action the Association takes under this Section B-20 against Owner or Owner's tenant, and to collect any outstanding amounts owed by Owner to the Association.

## **PART C**

### **ARCHITECTURAL CONTROL COMMITTEE**

**C-1) Membership.** Declarant shall establish an Architectural Control Committee (the "**Committee**") consisting of three (3) members. So long as Declarant has title to any Lot subject to this Declaration, the Committee shall be appointed by Declarant. After Declarant no longer has title to any Lot within the Development or at such earlier time as determined by the Declarant, the initial members of the Committee shall resign and the Association shall elect three (3) Owners to serve on the Committee. At any time, Declarant may elect to surrender the selection of the members of the Committee to the Association.

A majority of the Committee may designate a representative to act for it. In the event of the death or resignation of any member of the Committee, the remaining members shall have full authority to designate a successor.

The Committee appointed hereunder shall serve for the time period specified in paragraph C-10, below. Any Committee member may resign prior to said date. Such resignation shall be effective upon receipt. If a resignation shall occur, prior to turning over control of the Committee, then the remaining members of the Committee may appoint a replacement.

**C-2) Architectural Control.** No structure, whether residence, accessory building, tennis or sport court, swimming pool, decks, patios, antenna (whether located on a structure or on a Lot), flag pole, wall, fence, landscaping, recreational equipment or other improvements, including exterior colors and materials to be applied to said improvements, shall be constructed, maintained or performed upon any Lot and no alteration or repainting of the exterior of a structure shall be made unless complete Architectural Review Application (“**Application**”). Plans, specification and plot plans therefore shall have been submitted to and approved in writing by a majority of the Committee. Approval shall also be required for location of improvements with respect to topography and finish grade elevation. Said Application, plans, specifications and plot plans shall show the exterior design, height, building materials and color scheme thereof, the location of the structure plotted horizontally and vertically, the location and size of driveways, the plans for required landscaping, and the grading plan. A copy of such Application, plan specifications and plot plans as finally approved shall be deposited with the Committee. The Application can be found on the Veridian Homes website [www.veridianhomes.com](http://www.veridianhomes.com). Select Homeowner Resources (located on the top toolbar), select Architectural Control Committee and select the appropriate application for your request.

**C-3) Plan Review.** The Committee shall review said Application, plans and specifications as to quality of workmanship and materials, harmony of external design with existing or proposed structures and as to location with respect to topography and finish grade elevation. The Committee shall use the guidelines set forth in this Declaration as an aid in exercising its architectural control responsibilities hereunder, but nothing contained herein or therein shall limit the Committee’s discretion to grant variances from or make changes to, the guidelines, as they shall determine in the sole exercise of their discretion.

**C-4) Procedure.**

**A)** Neither the members of the Committee nor its designated representative shall be entitled to any compensation for services performed pursuant to this covenant for the initial approval of a residential structure. Thereafter, said Committee may charge a “request for action” or “approval” fee not to exceed Fifty and no/100 Dollars (\$50.00) for each such request or approval. The Committee’s approval or disapproval, as required in these Covenants, shall be in writing. In the event the Committee fails to provide, in writing, approval or disapproval within thirty (30) days after application, plans and specifications or any other matters requiring approval have been submitted to it, the request shall be deemed denied.

**B)** A submission will not be complete, and the thirty (30)-day approval time, as applicable, set forth above shall not commence until all documents required herein have been submitted. All such submissions shall be made to the Committee at the address set forth in this Declaration or to such other address that the Committee may designate.

C) The Committee shall have the sole right to reject any Application and plans which, in the judgment and sole opinion of a majority of its members are not in conformity with this Declaration; or are not desirable for aesthetic reasons; or are not in harmony with buildings located on the surrounding Lots; or are not in conformity with the general purposes of this Declaration.

D) The Committee shall exercise its sole approval authority and discretion in good faith and each Owner, by acceptance of a deed to, or any other interest in, a Lot, agrees to hold the Committee harmless from any perceived discrepancies in the Committee's good-faith performance of its duties. Refusal of approval of plans by the Committee may be based on any grounds, including purely aesthetic grounds, which in the sole discretion of the Committee shall be deemed sufficient.

E) The Committee may set its own operating procedures consistent with this Declaration and any limitations hereafter imposed by the Association. The costs of operating the Committee shall be assessed by the Association as Common Property expenses, except as permitted below. The Committee may engage consultants (e.g., architects, engineers or attorneys) either on a general or on a case-by-case basis, and the costs thereof may be charged to an applicant. The members of the Committee shall not draw any compensation for serving thereon but may be reimbursed for expenses incurred in performing their duties. All funds relating to the Committee shall be handled by the Association.

**C-5) Separate City Approval.** Matters which require approval of the Committee may also require approval of the City. Obtaining approval from the Committee and the City is solely the responsibility of the Owner desiring approval. Approval of Plans by the Committee shall not be deemed approval by the City and approval by the City shall not be deemed approval by the Committee.

**C-6) Records.** Until such time as a replacement Committee is designated, all plans, applications and requests shall be submitted to said Committee at the following address:

Crescent Crossing Homeowners Association, Inc.  
Architectural Control Committee  
100 River Place Suite 1  
Madison, Wisconsin 53713  
[acc@dsirealestate.com](mailto:acc@dsirealestate.com)

**C-7) Committee Liability.** Neither the Committee nor any member thereof shall be liable for damages to any person submitting request for approval or to any Owner of any Lot by reason of any action, failure to act, approval, disapproval or failure to approve or disapprove with regard to such requests. The Committee is not responsible for ensuring that the application and plans submitted by an Owner are in compliance with applicable laws, rules, regulations, ordinances or customary and typical building practices. The Committee does not review plans for structural design.

**C-8) Indemnification.** Each member or former member of the Committee, together with the personal representatives and heirs of each such person, shall be indemnified by the Association against all loss, costs, damages and expenses, including reasonable attorney's fees, asserted against, incurred by or imposed in connection with or resulting from any claim, action, suit or proceeding, including criminal proceedings, to which such person is made or threatened to be made a party by reason of service as a member thereof, except as to matters resulting in a final determination of gross negligence or willful misconduct on the part of such member. In the event of settlement of such proceeding, indemnification shall be provided only in connection with such matters covered by the settlement as to which the Association is advised by counsel that the person to be indemnified has not been guilty of gross negligence or willful misconduct in the performance of such person as a member in the matter involved. This right

of indemnification shall be in addition to all other rights and defenses. All liabilities, losses, damages, costs and expenses incurred or suffered by the Association in connection with this indemnification shall be a Common Property expense. Nothing in this Section C-8 shall be deemed an indemnification of such person with respect to such person's status as an Owner, occupant or otherwise.

**C-9) Variance.** The Committee shall have the power and absolute discretion to authorize a variance from any of the requirements of this Declaration if it finds that the strict application thereof would, in its sole discretion and opinion, result in difficulties or undue hardship to the Lot owner or in the event the architecture of the proposed Lot improvement is such as to present, in its opinion, a particularly pleasing appearance compatible with other houses in the development.

**C-10) Successor to Committee.** Declarant may turn over control of the Committee to the Members of the Association at any time, and shall turn over control when Declarant no longer has any ownership interest in the Property. At such time as Declarant turns over Committee control, the Association's Board of Directors shall designate not less than three (3) or more than five (5) Members of the Association to serve and act as the Committee for all purposes hereunder.

## **PART D** **DESIGN GUIDELINES**

### **D-1) Single Family Dwelling Units / Twin Home Dwelling Units.**

**A)** Dwelling unit siting, form and construction shall be in accordance with PDD documents approved by City of Fitchburg as applicable to this development.

**B) Architectural Character.** Architecture within the development will be developed with a unified architectural theme of mid-century modern as well as contemporary interpretations of regional styles. The overall character of the development will be created to establish a cohesive appearance throughout the community.

The requirements as itemized in the following section will be used as applicable to the context of the specific architectural style. Declarant reserves the right to grant variances in its sole discretion. Where city zoning is more restrictive, such requirements will govern.

**C) Front Porch.** Front porches are encouraged as both visual and functional design elements with a style consistent with the overall architectural style of the home and provide a visually appealing entry point. Minimum standard porch design details include the following; porch posts or alternate per plan, porch balustrades, when provided, of nominal 2" x 2" square wood at a maximum of six inches (6") on center; and newel posts that are compatible with the design of the column posts. Porch columns and railings shall be painted to match the trim color of the house.

**D) Garage.**

**1)** Garages shall be provided in accordance with PDD documents and specific unit plans.

**2)** The garage door shall be a raised panel design painted to match the siding on the home. The use of windows in the door, appropriate to the architectural style, is encouraged. The maximum single garage door size is 8' x 18".

**E) Ornamental Design Elements.**

- 1) While inherently more minimal in the overall architectural styles any ornamentation shall be consistent with these styles with emphasis on elevations exposed to public spaces.
- 2) Window wrap is required on front and other primary elevations facing a public space.
- 3) The window wrap and corner trim shall be minimum 3½” vinyl or composite material as approved by the Architectural Control Committee and used with box outs or when part of the standard plan.

**F) Roof/Facias/Soffits/Eaves.**

1. Roof Standards:

- a) Roof design must be consistent with the overall architectural style of the home. Roof forms and pitches as established on individual styles may not be altered without approval by the Architectural Control Committee.
- b) Roof material shall be Owens Corning Oakridge 30 architectural shingle or equal and in colors as approved by the Architectural Control Committee. Rubber roofing is allowed on flat roof areas and metal roofing is allowed on feature elements.
- c) Hip roof design, porches or other elements deemed appropriate by the Architectural Control Committee may be used in lieu of specific gable requirements.

2. Fascia, Soffit and Eave Standards:

- a) Fascia shall be 6” minimum aluminum with colors as approved by the Architectural Control Committee, wood or composite material may be used when appropriate to the architectural style.
- b) Aluminum soffit and eave color shall match fascia.
- c) A minimum 12” overhang is required at typical eaves and gable ends. However, 6” is allowable with projections less than 6’-0” in width, such as the fireplace chase, dormers and small bay windows. Larger overhangs may be required as appropriate to the architectural style.

**G) Exterior Wall Surfaces.**

- 1) Siding material shall be premium vinyl or composite material as approved by the Architectural Control Committee. Vertical board and batten siding is encouraged for accent areas appropriate to the style of the home. Colors shall be approved by the Architectural Control Committee.
- 2) Windows may be vinyl; vinyl clad, aluminum clad or wood with colors as approved by the Architectural Control Committee.

3) Variation of wall planes on primary elevations is encouraged as appropriate to architectural style and building scale. A front porch per section C may also be used to provide front elevation articulation as appropriate.

4) Any elevations facing public streets or spaces shall have a minimum of three (3) windows with wrap trim. Front door and garage windows may be included per specific building design.

5) The use of brick or stone is encouraged as appropriate to architectural style. Brick or stone facing must return a minimum of 2'-4" when terminated at an outside corner. Brick or stone material and color selections shall be as approved by the Committee and harmonious with overall neighborhood palette, as well as with the specific home design and be used consistently on all elevations.

6) **Colors.** The Declarant or the Architectural Control Committee, whichever is then applicable shall approve the trim, siding and roofing colors to assure the most aesthetic combination for a particular house as well as for the other Lots in the Plat. Any subsequent changes in such colors shall be approved by the Declarant or Committee, whichever is then applicable.

**D-2) Other Improvements.**

A) **Fences** All fencing must receive prior written approval of the Committee and shall comply with any requirements set out below. The Committee may also require the installation and maintenance of landscape materials for screening and aesthetic purposes. All fence material shall be constructed of vinyl. Zoning approval and/or building permit from the City may be required to construct fencing. Committee approval does not supersede the need for any municipal approvals or permits.

- 1) The fence style required is the PlyGem Breezewood Vinyl, Exhibit "E".
  - a) All fencing shall be erected finish side out ( i.e. pickets on the outside of the rail facing the street or neighboring lot).
  - b) Posts shall be spaced a minimum of 72" and a maximum of 96" on center. Rails shall be discontinuous and abut into the posts.
  - c) Gates are permitted and shall be consistent with the fencing style. All gates shall open into the lot. Gates may be required for access to utility easements.
  - d) Fencing color by PlyGem Fence/Railing of White is the only color permitted.
- 2) Appropriate uses of fencing:
  - a) Fencing shall be limited to rear and side yards only.
  - b) Fencing shall meet up with the corners of the home or garage and may not project past the front face of home or garage.
  - c) Only one fence is permitted along adjoining properties. Corners of adjoining properties fencing shall intersect at common corners.

- d) Fencing at side yards of corner lots shall be placed a minimum of 6 inches from the property line (approximately 1 foot from sidewalk) for all zoning classifications.

3) Inappropriate use of fencing:

- a) Fencing in front yards shall not be permitted.
- b) Fencing shall not occur in freestanding segments or be placed arbitrarily.
- c) Fencing shall not meet porch or deck corners.
- d) Fencing shall not interfere with utility equipment. Your utility companies shall be consulted for current requirements and the most restrictive shall apply.

**B) Decks.** All decks must receive prior written approval of the Committee and shall comply with any requirements set out below. The Committee may also require the installation and maintenance of landscape materials for screening and aesthetic purposes. A zoning approval or building permit from the City may be required to construct a deck. Committee approval does not supersede the need for any municipal approvals or permits.

1) Appropriate deck design shall incorporate the following criteria:

- a) Deck(s) shall be proportionate in size to the footprint of the dwelling
- b) Deck(s) shall be proportionate in length and width
- c) Deck(s) shall not project past the rear or side yard setbacks
- d) Deck(s) at side yards of corner lots may not project past the corner of the home or garage for that side facing the street.
- e) Deck(s) must be stained or painted

2) Inappropriate deck design:

- a) Deck(s) in front yards shall not be permitted.
- b) Deck(s) shall not occur in freestanding segments or be placed arbitrarily on the lot.
- c) Deck(s) shall not interfere with utility equipment. Your utility companies shall be consulted for current requirements and the most restrictive shall apply.

**C) Outbuildings.** No outbuilding, shed or accessory building of any nature shall be erected on any Lot, with the exception of a detached garage that is the only garage on the lot and is approved by the Committee prior to construction. Secondary units (granny flats) above detached garages may be allowed with prior written approval from the ACC.

**D) Antennae/Wind Powered Electric Generators.** No wind powered electric generators, exterior television, radio receiving or transmission antennae, satellite signal receiving station

or dish shall be placed or maintained upon any portion of a Lot without prior written approval of the Committee.

- 1) Appropriate antennae or satellite dish placement:
  - a) Only one antennae or satellite dish shall be allowed per lot.
  - b) The location of the satellite dish can be any of the following and shall not be visible from the curb directly in front of the home:
    - i. On a pole in the backyard and located close to the home.
    - ii. Attached to the deck.
    - iii. On the rear roof line of the home.
      1. A satellite dish shall not project past the uppermost roof ridgeline. This method is not recommended by the Committee as you may have water infiltration issues if the dish is not properly installed and roof repairs may not be covered under the applicable roof warranty.
- 2) Inappropriate antennae or satellite dish placement:
  - a) Antennae or satellite dish in front or side yards shall not be permitted.
  - b) Antennae or satellite dish shall not interfere with utility equipment.

**E) Firewood Storage.** No firewood or woodpile shall be kept on any lot unless it is neatly stacked, placed in the rear yard and screened from street view by plantings or a fence first approved in writing by the Committee.

**F) Solar Collectors.** No active solar collector or apparatus may be installed on any Lot unless such installation is first approved in writing by the Committee, which shall consider the aesthetic and sun reflection effects on neighboring structures. Solar collectors or apparatus installed flat against or parallel to the plane of the roof shall be preferred.

**G) Lighting.** Exterior lighting installed on any Lot shall either by indirect or of such controlled focus and intensity that such lighting will not disturb the residents of adjacent Lots.

**H) Landscaping Requirements.** Pursuant to Section B-4 of the Declaration of Conditions, Covenants and Restrictions, Developer hereby imposes upon all Lots described in Exhibit "A", attached hereto and incorporated herein by reference, the requirement that the Owners thereof install landscaping on such Lots which meets or exceeds the minimum number of points for landscaping set forth in Exhibit "C". The number of points attributable to various elements of the landscaping to be installed shall be determined by reference to Exhibit "D", attached hereto and incorporated herein by reference. All terms, covenants and conditions of Section B-4 of the Declaration of Conditions, Covenants and Restrictions, as amended herein, shall be applicable to the landscaping to be installed pursuant to the terms of this paragraph. Landscape installed by the Declarant may or may not meet the minimum number required.

**PART E**  
**GENERAL PROVISIONS**

**E-1) Term.** This Declaration shall run with the property described on Exhibit "A" attached hereto, and shall be binding on Declarant and all Owners and their successors and assigns, and all persons claiming under them for a period of twenty-five (25) years from the date recorded, after which time said Declaration shall be extended automatically for successive periods of five (5) years each unless an instrument signed by a majority of the Owners agreeing to change said Covenants in whole or in part or to terminate the same.

**E-2) Enforcement.** The Declarant (or either one of them if more than one), the Association or Management Company on behalf of the Association, or any Owner shall have the right to enforce by any proceedings at law or in equity all restrictions, conditions and covenants created or imposed herein, against any person or persons violating or attempting to violate any covenant, by any action to either restrain violation or to recover damages, or both including reasonable attorney fees. The Architectural Control Committee may refer any violation which shall come to its attention to the Declarant or Association for action under the terms of this paragraph and this Declaration. Failure to enforce any covenant, condition or restriction herein shall in no event be deemed a waiver of the right to do so thereafter. In the event of a violation of this Declaration the Association shall have the right to assess and collect from the violating party a fine (the "**Fine**") for such violation equal to the greater of (i) the actual damages suffered on account of the violation, or (ii) the sum of \$100.00 per day for each day the violation remains outstanding plus (iii) all costs of collection and enforcement, including actual attorney fees. Any Fine imposed by the Association or the Management Company acting on its behalf, may be assessed against the Owner(s) by means of a Special Assessment against the Lot or Lots owned by the Owner in violation. In such event, the Association, or the Management Company acting on its behalf, shall have all rights provided in Section A-4 (C) (3), above, regarding collection of Special Assessments and foreclosure of the lien thereof.

**E-3) Severability.** Invalidation of any one of these covenants by judgment or court order shall in no way affect any of the other provisions which shall remain in full force and effect.

**E-4) Model Homes.** So long as Declarant shall own any Lot in the Development, Declarant shall be permitted to maintain model homes in the Development, including therein a sales office for the purpose of sales and marketing of its homes.

**E-5) Parade of Homes and/or Condominiums.** So long as Developer shall own any Lots in the Development, or condominium units in any condominium located within the Development (collectively a "Lot/Unit"). Developer reserves the right to submit some or all of said Lots/Units as a site for the Parade of Home and/or the Parade of Condominiums of the Madison Area Builders Association (the "Parade"). In the event that some or all of said Lots/Units are selected as a site for a Parade, this Declaration of Protective Covenants, Conditions and Restrictions shall, as to the Lots/Units enrolled in the Parade, for a limited period of time ending 48 hours after the conclusion of the Parade, be deemed temporarily altered and modified, to the extent necessary, to permit the Madison Area Builders Association to hold its Parade in this Development pursuant to the then current Parade Rules and Checklist of the Madison Area Builders Association. All purchasers of Lots/Units, and/or their successors and assigns, shall take title subject to this specific reservation by the Developer and shall waive all rights to object to violations of this Declaration of Protective Covenants, Conditions and Restrictions by the Developer, the Madison Area Builders Association, or any of the builders or participants in the Parade for the period of the Parade as set forth above, including the closing of any public or private streets in the Parade area. All Lot/Unit owners appoint the Developer their attorney-in-fact to execute all necessary petitions; applications and consents to facilitate said street closings for the Parade.

**E-6) Governing Law.** This Declaration shall be construed and enforced in accordance with the terms of the laws of the State of Wisconsin. The terms of this Declaration are not intended to replace or affect any applicable laws, ordinances, rules or regulations of the City.

**E-7) Notices.**

A) Notices to Declarant shall be given to Declarant at the following address: 6801 South Towne Drive, Madison, WI53713.

B) Notices to an Owner of any Lot within the Development shall be given in care of the street address of the Lot.

C) Any party may change its address by written notice given to the other parties. Party, its successors and/or assigns, may change said addresses by notice properly given hereunder.

**E-8) Amendment and Release.** At any time until Declarant conveys all of the Lots which comprise the entire Property, or turns control of the Association over to the Class A Members, whichever occurs first, Declarant may modify, amend, alter and grant variances to this Declaration without the consent of any Member, Owner or Occupant, their Mortgagees or any other party, including the Association and its Board of Directors. These restrictions or any part thereof may be cancelled, released or amended in writing as to the entire Plat or any part thereof by the Declarant at any time until Declarant conveys all of the Lots or until the Declarant turns over control to the Committee, whichever comes first. After the Declarant has sold all of the Lots or otherwise released or assigned its right to enforce this Declaration, then this Declaration or any part thereof may be released, cancelled, amended or waived by an instrument approved by a majority of the Class A Members and all of the Class B Members and executed by the Association hereof in accordance with the provisions of Section E-1, above.

**E-9) No Waiver.** Whenever a waiver, consent or approval is required or permitted herein, it must be express and in writing; no waiver, consent or approval shall be implied. Failure to enforce any provision of this Declaration shall not operate as a waiver of any such provision or any other provision of this Declaration.

**E-10) Number and Gender.** Whenever used herein, unless the context shall otherwise provide, the singular shall include the plural, the plural shall include the singular, and the use of any gender shall include all genders.

**E-11) Including.** Whenever used herein, the term “including” preceding a list of one or more items shall indicate that the list contains examples of a general principle and is not intended as an exhaustive listing.

**E-12) Captions.** The captions and article and section headings in this Declaration are intended for convenience and reference only and in no way define or limit the scope or intent of the various provisions hereof.

**E-13) Remedies.** All remedies herein are cumulative.

**[See attached signature page.]**

IN WITNESS WHEREOF, the said VH CC, LLC, a Wisconsin Limited Liability Company has caused these presents to be signed and sealed this 27 day of January, 2021.

VH CC, LLC  
By: VH Holdings, LLC, Its Sole Member

By: [Signature]  
Chris Ehlers, Authorized Signatory

STATE OF WISCONSIN    )  
  ) ss  
COUNTY OF DANE        )

Personally came before me this 27 day of January, 2021, Chris Ehlers the Authorized Signatory of VH CC, LLC a Wisconsin Limited Liability Company, to me know to be such persons and officers who executed the foregoing instrument and acknowledged that they executed the same as such officers, by its authority for the purposes therein contained.

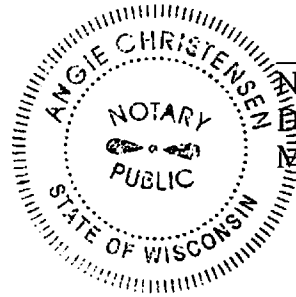

[Signature]  
Notary Public  
Dane County, Wisconsin  
My Commission Expires: May 1, 2024

This document was drafted by:  
  
Gregory J. Paradise  
Mohs Widder Paradise LLC  
20 North Carroll Street  
Madison, WI 53703

**CONSENT OF MORTGAGEE**

The undersigned, First Business Bank, hereby consents to the forgoing Declaration of Conditions, Covenants and Restrictions for the plat of Crescent Crossing. This consent does not limit, restrict or affect in any way Mortgagee's rights, interest and remedies regarding Mortgagee's interest in the Property.

Dated this 21<sup>st</sup> day of January, 2021.

**FIRST BUSINESS BANK**

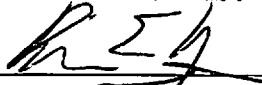
By: 

Print Name: Brian E. Hagen

Print Title: Senior Vice President

STATE OF WISCONSIN    )  
  ) SS.  
COUNTY OF DANE        )

Personally came before me this 21<sup>st</sup> day of January, 2021, the above-named Brian E. Hagen to me known to be the person who executed the foregoing instrument and acknowledged that they executed the same for the purposes therein contained.

  
Notary Public, Dane County, WI  
My Commission Expires: Oct. 29, 2022



**Exhibit "A"**

**Description of Crescent Crossing**

**Lots 1-117 and Outlots 1-11, Crescent Crossing, located in the City of Fitchburg, Dane County,  
Wisconsin**

**Exhibit "A"**

225/

Lot	PIN	Address
1	0609-083-4001-2	2581 Wildcat Drive 5889 Minong Lane
2	0609-083-4012-2	2582 Wildcat Drive
3	0609-083-4023-2	2583 Wildcat Drive
4	0609-083-4034-2	2584 Wildcat Drive
5	0609-083-4045-2	2585 Wildcat Drive
6	0609-083-4056-2	2586 Wildcat Drive
7	0609-083-4067-2	2587 Wildcat Drive
8	0609-083-4078-2	2588 Wildcat Drive
9	0609-083-4089-2	2589 Wildcat Drive
10	0609-083-4100-2	2590 Wildcat Drive
11	0609-083-4111-2	2591 Wildcat Drive
12	0609-083-4122-2	2592 Wildcat Drive
13	0609-083-4133-2	2593 Wildcat Drive
14	0609-083-4144-2	2594 Wildcat Drive
15	0609-083-4155-2	2595 Wildcat Drive
16	0609-083-4166-2	2596 Wildcat Drive
17	0609-083-4177-2	2597 Wildcat Drive
18	0609-083-4188-2	2598 Wildcat Drive
19	0609-083-4199-2	2599 Wildcat Drive
20	0609-083-4210-2	2600 Wildcat Drive
21	0609-083-4221-2	2601 Wildcat Drive
22	0609-083-4232-2	2602 Wildcat Drive
23	0609-083-4243-2	2603 Wildcat Drive
24	0609-083-4254-2	2604 Wildcat Drive
25	0609-083-4265-2	2605 Wildcat Drive
26	0609-083-4276-2	2606 Wildcat Drive
27	0609-083-4287-2	2607 Wildcat Drive
28	0609-083-4298-2	2608 Wildcat Drive
29	0609-083-4309-2	2609 Wildcat Drive
30	0609-083-4320-2	2610 Wildcat Drive
31	0609-083-4331-2	2611 Wildcat Drive
32	0609-083-4342-2	2612 Wildcat Drive
33	0609-083-4353-2	2613 Wildcat Drive
34	0609-083-4364-2	2614 Wildcat Drive
35	0609-083-4375-2	2615 Wildcat Drive
36	0609-083-4386-2	2616 Wildcat Drive
37	0609-083-4397-2	2617 Wildcat Drive
38	0609-083-4408-2	2618 Wildcat Drive
39	0609-083-4419-2	2619 Wildcat Drive
40	0609-083-4430-2	2620 Wildcat Drive
41	0609-083-4441-2	2621 Wildcat Drive
42	0609-083-4452-2	2622 Wildcat Drive
43	0609-083-4463-2	2623 Wildcat Drive
44	0609-083-4474-2	2624 Wildcat Drive
45	0609-083-4485-2	2625 Wildcat Drive

Lot	PIN	Address
46	0609-083-4496-2	2626 Wildcat Drive
47	0609-083-4507-2	2627 Wildcat Drive
48	0609-083-4518-2	2628 Wildcat Drive
49	0609-083-4529-2	2629 Wildcat Drive
50	0609-083-4540-2	2630 Wildcat Drive
51	0609-083-4551-2	2631 Wildcat Drive
52	0609-083-4562-2	2632 Wildcat Drive
53	0609-083-4573-2	2633 Wildcat Drive
54	0609-083-4584-2	2634 Wildcat Drive 2573 Spark Street
55	0609-083-4595-2	2635 Wildcat Drive
56	0609-083-4606-2	2636 Wildcat Drive
57	0609-083-4617-2	2637 Wildcat Drive
58	0609-083-4628-2	2638 Wildcat Drive 2552 Wildcat Drive
59	0609-083-4639-2	2639 Wildcat Drive
60	0609-083-4650-2	2640 Wildcat Drive
61	0609-083-4661-2	2641 Wildcat Drive
62	0609-083-4672-2	2642 Wildcat Drive
63	0609-083-4683-2	2643 Wildcat Drive
64	0609-083-4694-2	2644 Wildcat Drive
65	0609-083-4705-2	2645 Wildcat Drive
66	0609-083-4716-2	2646 Wildcat Drive
67	0609-083-4727-2	2647 Wildcat Drive
68	0609-083-4738-2	2648 Wildcat Drive
69	0609-083-4749-2	2649 Wildcat Drive
70	0609-083-4760-2	2650 Wildcat Drive
71	0609-083-4771-2	2651 Wildcat Drive
72	0609-083-4782-2	2652 Wildcat Drive
73	0609-083-4793-2	2653 Wildcat Drive
74	0609-083-4804-2	2654 Wildcat Drive
75	0609-083-4815-2	2655 Wildcat Drive
76	0609-083-4826-2	2656 Wildcat Drive
77	0609-083-4837-2	2657 Wildcat Drive
78	0609-083-4848-2	2658 Wildcat Drive
79	0609-083-4859-2	2659 Wildcat Drive
80	0609-083-4870-2	2660 Wildcat Drive
81	0609-083-4881-2	2661 Wildcat Drive
82	0609-083-4892-2	2662 Wildcat Drive
83	0609-083-4903-2	2663 Wildcat Drive 2606 Wildcat Drive
84	0609-083-4914-2	2664 Wildcat Drive
85	0609-083-4925-2	2665 Wildcat Drive

Lot	PIN	Address
86	0609-083-4936-2	2666 Wildcat Drive 2701 Spark Street
87	0609-083-4947-2	2667 Wildcat Drive
88	0609-083-4958-2	2668 Wildcat Drive
89	0609-083-4969-2	2669 Wildcat Drive
90	0609-083-4980-2	2670 Wildcat Drive 2612 Wildcat Drive
91	0609-083-4991-2	2671 Wildcat Drive
92	0609-083-5002-2	2672 Wildcat Drive
93	0609-083-5013-2	2673 Wildcat Drive
94	0609-083-5024-2	2674 Wildcat Drive
95	0609-083-5035-2	2675 Wildcat Drive
96	0609-083-5046-2	2676 Wildcat Drive
97	0609-083-5057-2	2677 Wildcat Drive
98	0609-083-5068-2	2678 Wildcat Drive
99	0609-083-5079-2	2679 Wildcat Drive
100	0609-083-5090-2	2680 Wildcat Drive
101	0609-083-5101-2	2681 Wildcat Drive
102	0609-083-5112-2	2682 Wildcat Drive
103	0609-083-5123-2	2683 Wildcat Drive
104	0609-083-5134-2	2684 Wildcat Drive
105	0609-083-5145-2	2685 Wildcat Drive
106	0609-083-5156-2	2686 Wildcat Drive
107	0609-083-5167-2	2687 Wildcat Drive
108	0609-083-5178-2	2688 Wildcat Drive
109	0609-083-5189-2	2689 Wildcat Drive
110	0609-083-5200-2	2690 Wildcat Drive
111	0609-083-5211-2	2691 Wildcat Drive
112	0609-083-5222-2	2692 Wildcat Drive
113	0609-083-5233-2	2693 Wildcat Drive
114	0609-083-5244-2	2694 Wildcat Drive
115	0609-083-5255-2	2695 Wildcat Drive
116	0609-083-5266-2	2696 Wildcat Drive
117	0609-083-5277-2	2697 Wildcat Drive 5890 Minong Lane
OUTLOT 1	0609-083-5300-2	
OUTLOT 2	0609-083-5325-2	
OUTLOT 3	0609-083-5350-2	
OUTLOT 4	0609-083-5375-2	
OUTLOT 5	0609-083-5400-2	
OUTLOT 6	0609-083-5425-2	
OUTLOT 7	0609-083-5450-2	
OUTLOT 8	0609-083-5475-2	
OUTLOT 9	0609-083-5500-2	
OUTLOT 10	0609-083-5525-2	
OUTLOT 11	0609-083-5550-2	

**Exhibit "B"**

Please be advised that the Declarant hereby directs viewers to ignore the printed text material on the maps attached to this Exhibit "B." Only the spacial relationships of the illustrators on the maps are being presented for your information.

**\*DECLARANT\***

**VH CC, LLC**

**BY: VH HOLDINGS, LLC, ITS SOLE  
MEMBER**

By: 

Print Name: Chris Ehlers

Print Title: Authorized Signatory

# Exhibit "B"

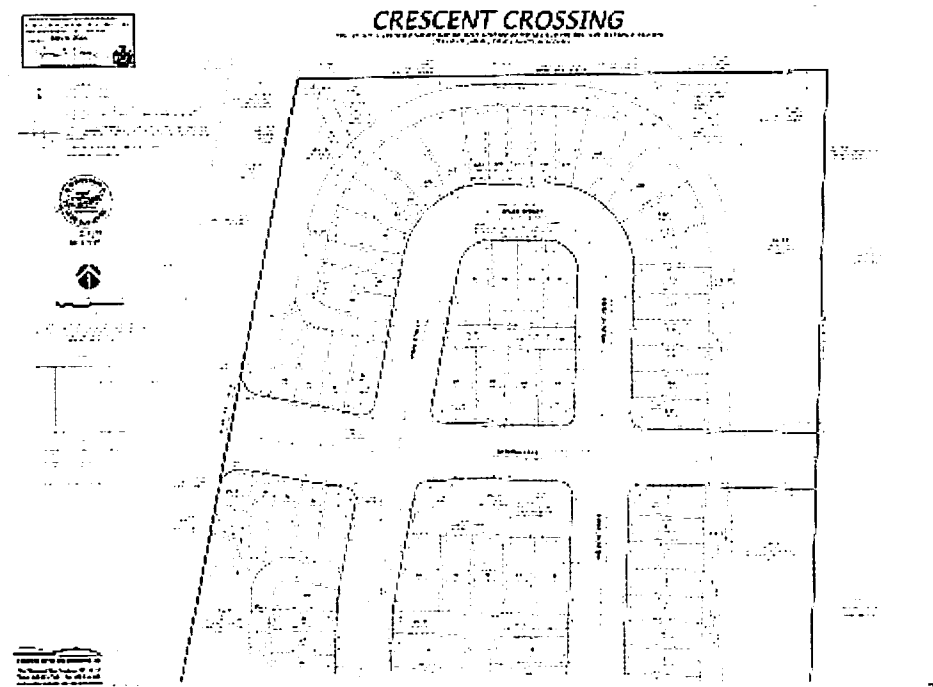
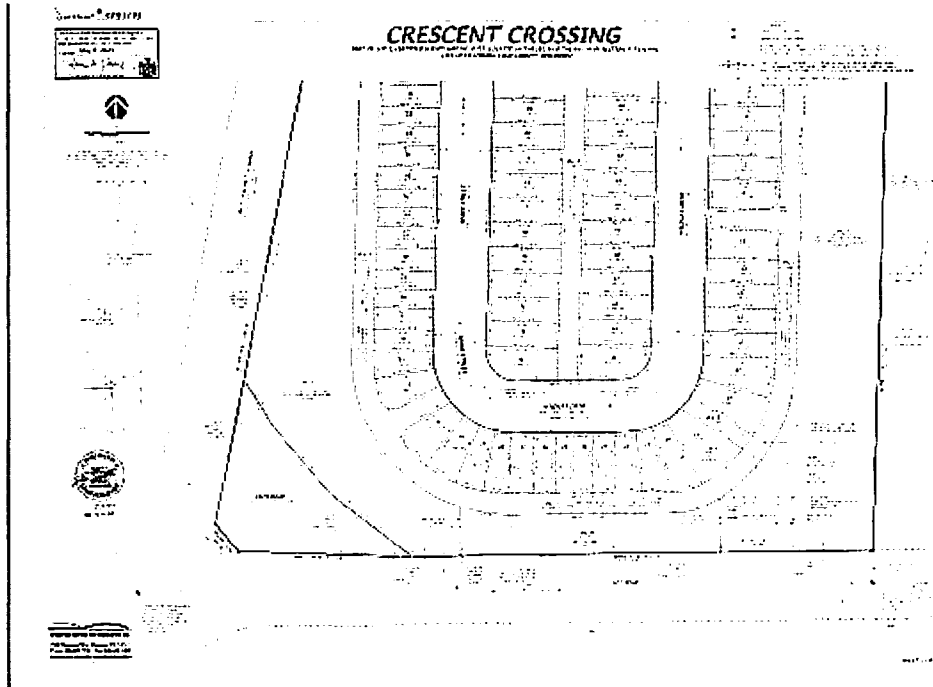

Viewers are advised to ignore the illegible text on this map. It is presented to show spatial relationships only.

**EXHIBIT "C"**

**Total Minimum Points for Landscaping**

<b>Lot(s)</b>	<b>Minimum Points for Foundation Plantings</b>	<b>Total Minimum Points for Landscaping</b>
<b>1-19, 54-90, 109-117</b>	<b>350</b>	<b>500</b>
<b>20-53, 91-108 (twins)</b>	<b>300</b>	<b>425</b>

**EXHIBIT "D"**  
**Landscaping Elements**

<b>Elements</b>	<b>Point Schedule</b>
A) <i>Small Shade Trees (balled and burlaped)</i> ..... (1.5"-2" caliper at 6" from the roots)	50
B) <i>Medium Shade Trees (balled and burlaped)</i> ..... (2"-3" caliper at 6" from the roots)	100
C) <i>Large Shade Trees (balled and burlaped)</i> ..... (3"-4" caliper at 6" from the roots)	150
D) <i>Extra-Large Shade Trees (balled and burlaped)</i> ..... (4" + caliper at 6" from the roots)	200
E) <i>Ornamental Trees (balled and burlaped)</i> ..... (1.5"-2" caliper at 6" from the roots)	50
F) <i>Small Evergreen Trees</i> ..... (3' to 4.5' when planted)	25
G) <i>Medium Evergreen Trees</i> ..... (5' to 6.5' when planted)	50
H) <i>Large Evergreen Trees</i> ..... (7' + when planted)	100
I) <i>Evergreen Shrubs</i> ..... (18" minimum diameter)	20
J) <i>Small Deciduous Shrubs</i> ..... (18" to 35" in diameter)	10
K) <i>Medium Deciduous Shrubs</i> ..... (35" to 60" in diameter)	15
L) <i>Large Deciduous Shrubs (balled and burlaped)</i> ..... (60" or greater in diameter)	25
M) <i>Decorative Retaining Walls</i> ..... (Points are per face foot. Boulders, timbers, and stones only – no concrete walls included.)	10
N) <i>Paver Stone Walks, Paths or Patios</i> ..... (Points per square foot – no driveways included.)	1
O) <i>Planting Beds</i> ..... (Points per square foot – must be decorative stone or mulch.)	1

The final point totals must consist of a balanced variety of the listed elements acceptable to the Architectural Control Committee. Existing vegetation, trees and shrubs may be included in the point totals if they are properly protected and maintained during the construction process and located as such on the landscape plans submitted to the Architectural Control Committee for approval.

Exhibit "E"

# BREEZEWOOD

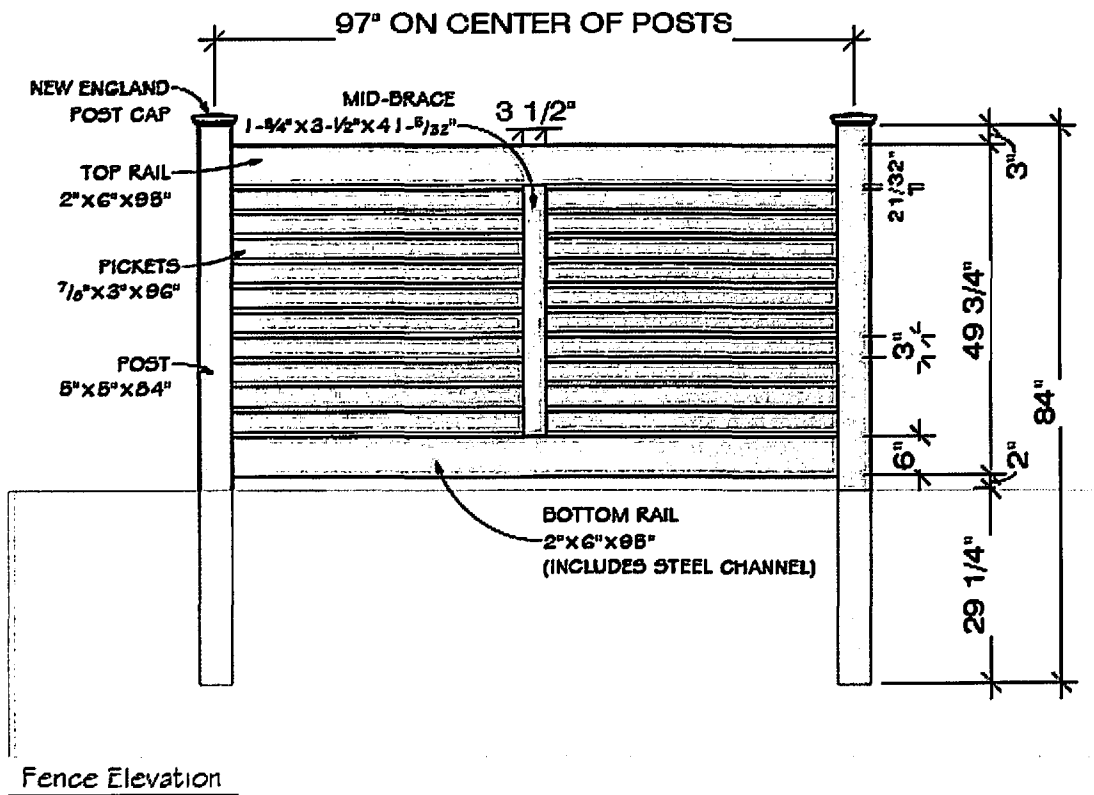
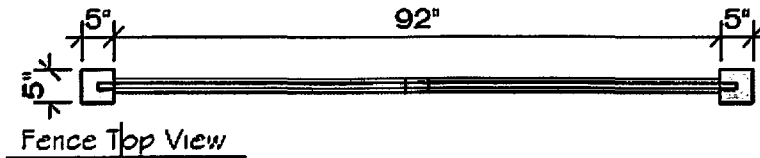

**NOTE:**  
MANDATORY REQUIREMENTS (NO VARIANCE WILL BE ALLOWED)

- FENCE MUST BE VINYL
- VINYL COLOR: "WHITE"
- FENCE STYLE IS A CERTAINTED PRODUCT (BREEZEWOOD)

• CUSTOM BUILT ON THE JOBSITE

Viewers are advised to ignore the illegible text on this map. It is presented to show spatial relationships only.



6801 South Towne Drive  
 Madison, WI 53713  
 Phone 609.226.3100  
 Fax 609.226.0600

# BREEZEWOOD

(Sideyard only adjacent to S. Seminole Hwy for Lots 50 and 94)

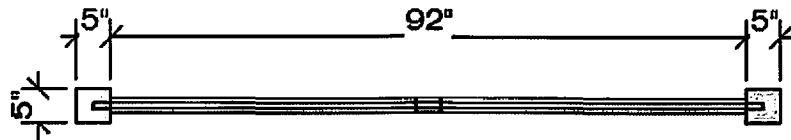

Fence Top View

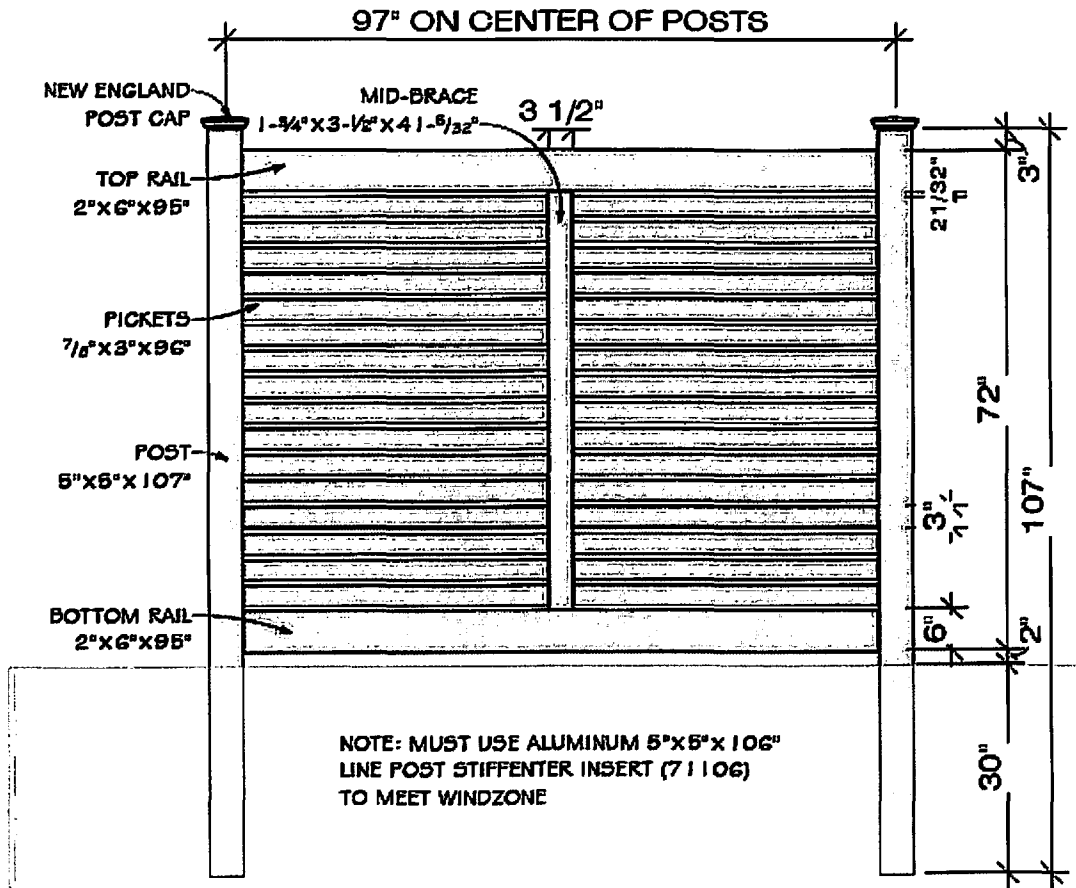

Fence Elevation

NOTE: MUST USE ALUMINUM 5"x5"x 106"  
LINE POST STIFFENER INSERT (71106)  
TO MEET WINDZONE

**NOTE:**

**MANDATORY REQUIREMENTS (NO VARIANCE WILL BE ALLOWED)**

- FENCE MUST BE VINYL
- VINYL COLOR: "WHITE"
- FENCE STYLE IS A CERTAINTED PRODUCT (BREEZEWOOD)

• CUSTOM BUILT ON THE JOBSITE

Viewers are advised to ignore the illegible text on this map. It is presented to show spatial relationships only.



6801 South Towne Drive  
Madison, WI 53713  
Phone 608.226.3100  
Fax 608.226.0800